

# **focus** *by* **IGNISIAL**

**E-GNIS DOMOFOCUS  
ELECTRONIC BURNER**

---

Installation and user manual



General information.....	03
Lexical sheet.....	05
Installation recommendations.....	07
Burner installation.....	08
Installing the ceramic log kit.....	13
Operating instructions.....	16
Filling the burner.....	17
Burner ignition.....	20
Burner off.....	21
Checking the burner status.....	22
Appendix: Control panel display.....	23
Appendix: Emptying the burner before moving.....	25

## 1. GENERAL

**Before use**, please read the following instructions very carefully and follow them to ensure that you use your fireplace safely.

The appliance must be installed in accordance with the manufacturer's instructions.

Failure to follow these instructions could result in damage to property (installation site, fireplace) as well as personal injury.

This appliance is for domestic use only.

The appliance must be protected from access by children, animals and unauthorised persons.

For indoor appliance use and only installed in a FOCUS fireplace.

The ethanol used must be at a temperature above 15°C at the time of loading and ignition.

## 2. WARNING

For proper use, the user must comply with the instructions supplied with the appliance and with the following instructions:

- It is forbidden to use this appliance on its own, out of a FOCUS fireplace, in caravans, boats and all types of vehicles...
- This appliance must not be used in insufficiently ventilated rooms below floor level.
- It is forbidden for the user to tamper with the burner safety devices.
- It is forbidden to use an ignition system other than that recommended by the manufacturer.
- Do not use the appliance in damp or draughty conditions.
- It is forbidden to have flammable or heat-sensitive objects within 800mm of the appliance.
- It is forbidden to place objects on the appliance (other than those suggested by the manufacturer).
- Ventilation slots must not be covered.
- It is forbidden to use any fuel other than that recommended in the instructions.
- This appliance is not suitable for continuous operation.
- This appliance is fitted with a safety system that prevents it from reigniting when hot.
- It is forbidden for the user to add any additives (essential oils, perfumes, etc.) to the fuel.
- The tank must be filled when the appliance is switched off and cold (fire safety).
- Comply with the conditions in force for fuel storage (e.g. health regulations, co-ownership regulations).
- Children must not fill or ignite the appliance.
- As the surfaces of the appliance can be hot, keep them out of the reach of children and away from any flammable materials.
- Do not throw anything into the appliance: rubbish, paper, etc.
- Never use the appliance to cook food or heat liquids.
- Do not dismantle the appliance.
- Do not block the burner.

**3. CHARACTERISTIC**

SPECIFICATIONS		
Use	Only indoor	
Recommended combustible	Bioethanol Aluflam ( <a href="https://ignisial-paris.com/bio-ethanol-aluflam/">https://ignisial-paris.com/bio-ethanol-aluflam/</a> ) or Denatured Bioethanol with a concentration between 96% and 96.6%, free of colorants	
Tank capacity	9 liters	
Power	2 batteries 12V	
Battery autonomy*	9 ignitions - 7 filling	
Remote control	2 buttons (ON - OFF)	
Decorative element	Ceramic logs	
Flame width	500 mm	
Dimensions (L x P x h)	1045 x 858 x 141 mm	
Weight without ethanol	30 kg	
Colour	Black	
Market	UE	
Guarantee	2 years (without accessories)	
Manufacturing	French	
SAFETY		
Ignition	Electronic	
Filling	Electronic Overflow Protection Pump	
CO2 sensor	Yes (Threshold of 1000 ppm)	
Refuelling and Ignition Not Possiblewhen appliance is hot		
INSTALLATION		
	NOT CONNECTED	CONNECTED
Nominal heat output	7 kW	9 kW
Maximal autonomy	8h	7h
Minimum room volume	125 m³	N/A
Air renewal rate	1 air change per hour	N/A
Minimum ceiling height	2m50	N/A

\* Data may vary with time and battery wear

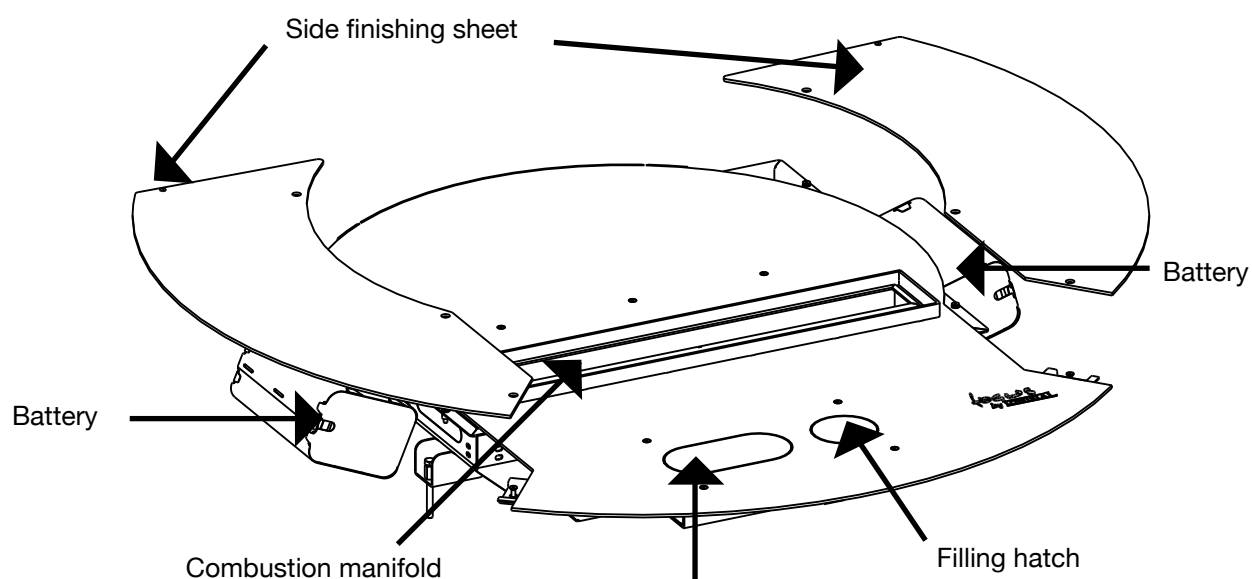
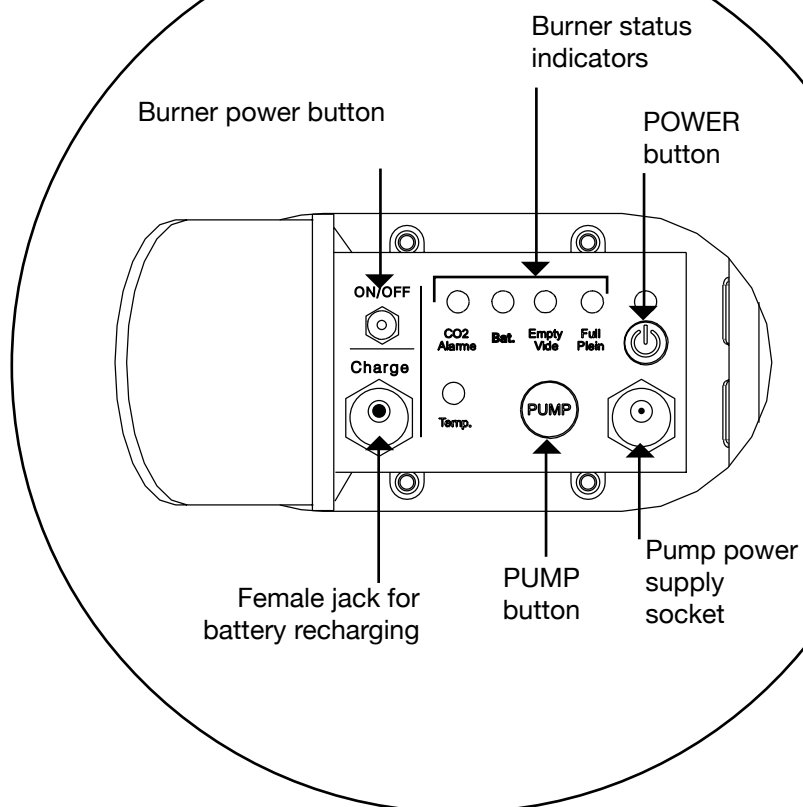

**1. BURNER****2. CONTROL PANEL**

**3. BATTERIES AND CHARGER**

x2

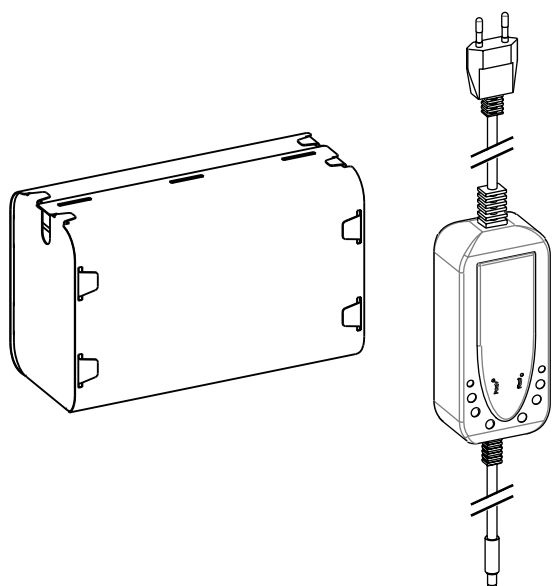
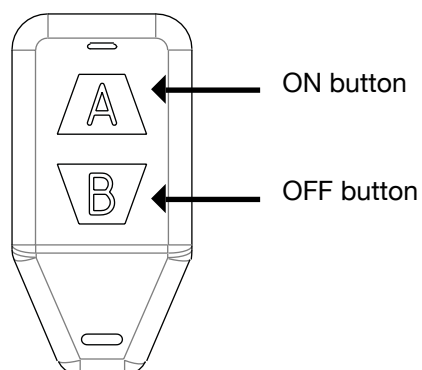
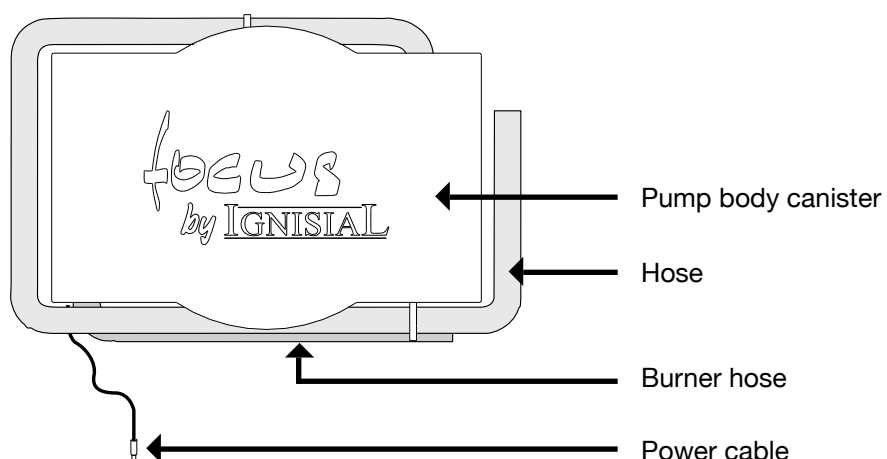
**4. REMOTE CONTROL****5. FILLING PUMP****SUPPLIED WITH :**

- Microfibre wipe
- Mounting wedge (x2)

**Before installing this appliance, it is absolutely essential that you take note of the following recommendations and follow them rigorously to ensure safe installation and prevent any potential hazards. Any installation that does not comply with these instructions will invalidate the guarantee on your appliance and will be your sole responsibility.**

This appliance can be installed in a Domofocus not connected to a flue or retrofitted in a Domofocus connected to a flue.

- **Case 1: Installation in a Domofocus not connected to a flue.**

 Before installing the burner, it is essential to install the fireplace in accordance with the instructions in the document supplied by Focus with the fireplace.



- **Case 2 : Installation in a Domofocus connected to a flue.**

 In the case of a retrofit, before installing the burner in the fireplace, the flue must be swept. Remove the fire grate. Remove the ash trap. Replacement of the rotation device bearing with a stainless steel bearing.





## Burner positioning

- 1 Position the wedges between the firebox opening and the burner.

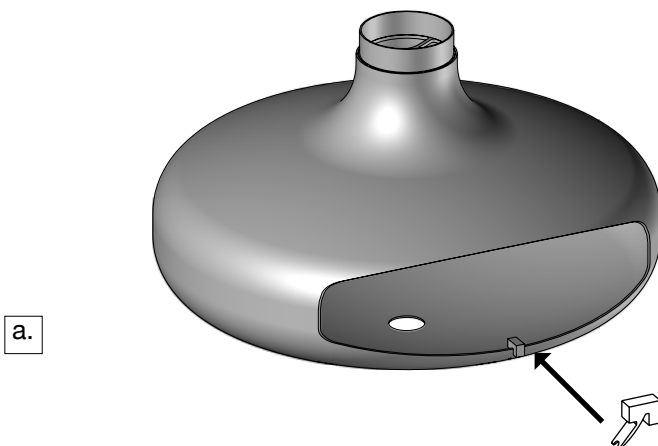

- 2 Insert the burner into the firebox

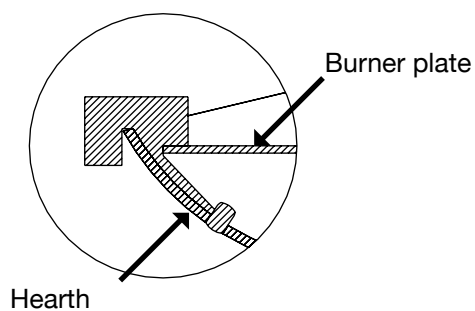
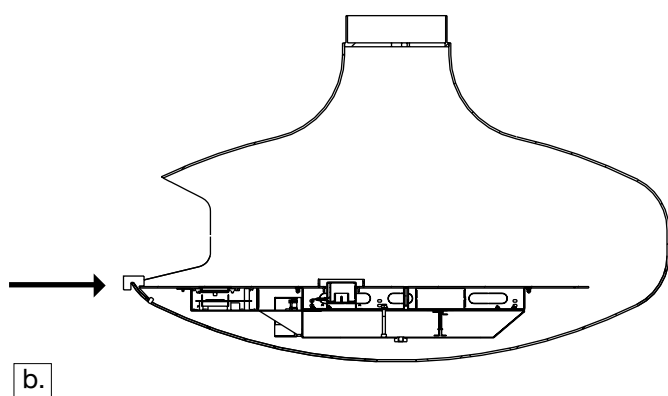

- 3 Position the burner so that gaplight «A» is even between the burner and the edge of the firebox opening on the left and on the right. Then remove the wedges.

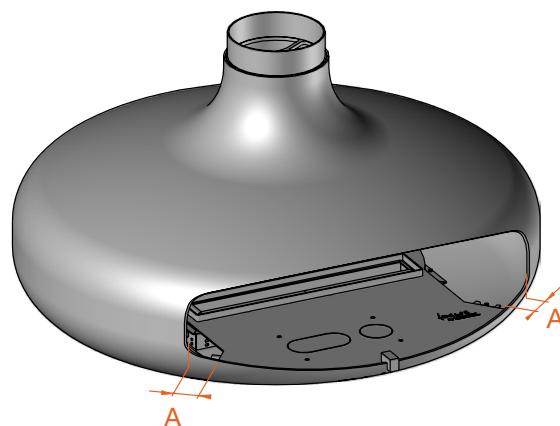
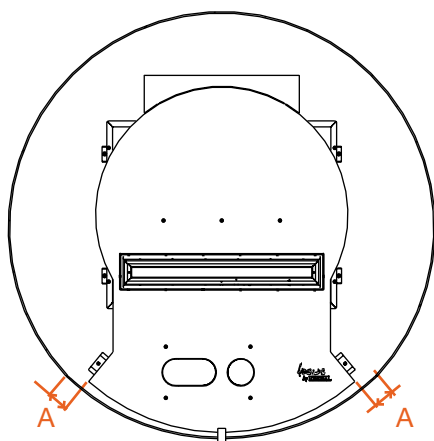



## Level the burner

- 4 Level the burner height along the side axis (take the level from the burner plate).  
The level is adjusted using the 4 screws (M6 H) .

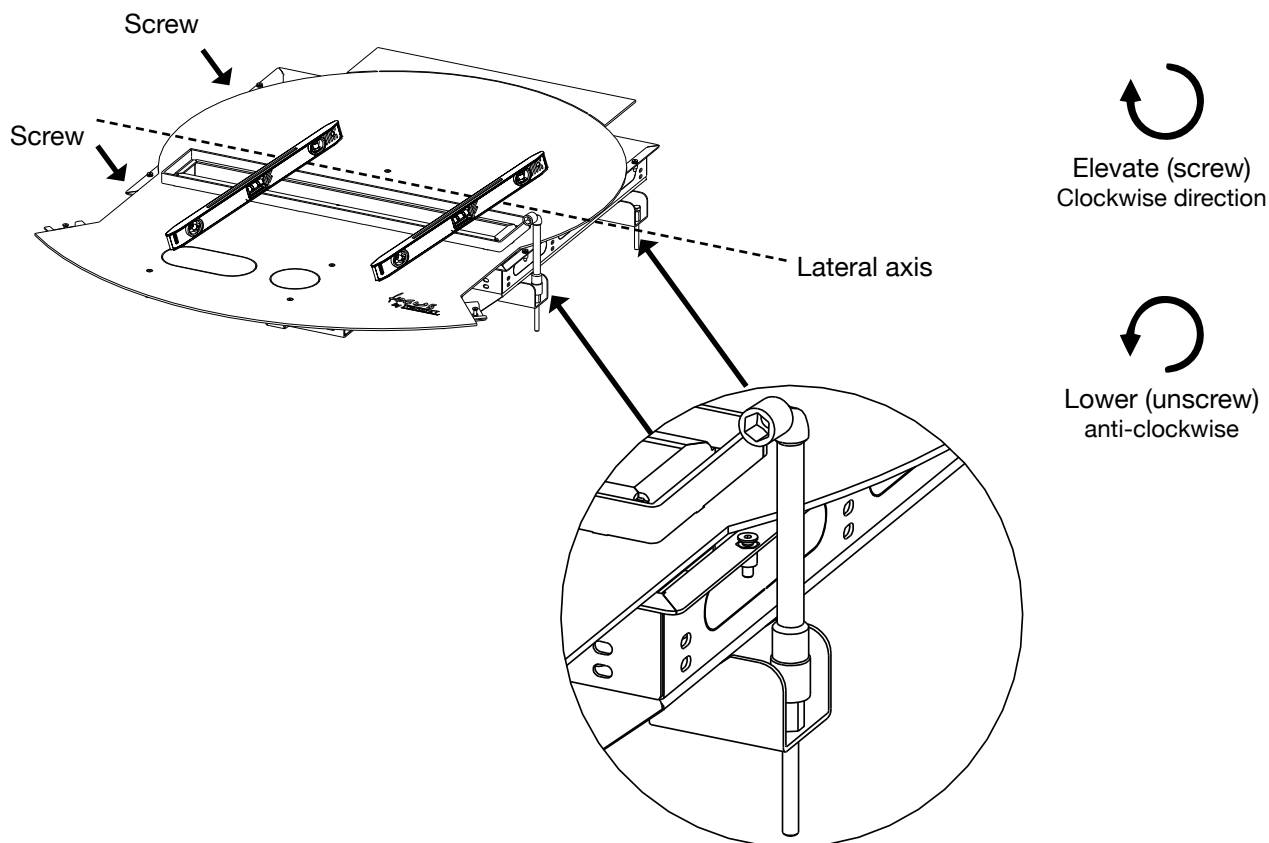

- 5 Level the burner along the longitudinal axis (take the level from the burner rail).  
In order not to affect the setting made in illustration **4** , adjust the two screws in the same way and the two other screws in reverse (for example : 1/4 turn and -1/4 turn).

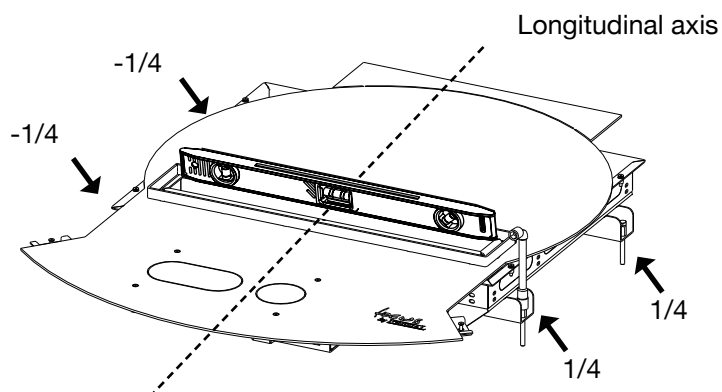

## Positioning the batteries

- 6 Remove the battery connection cables from the cover of the device.  
Then connect the batteries, observing the polarity of the battery.

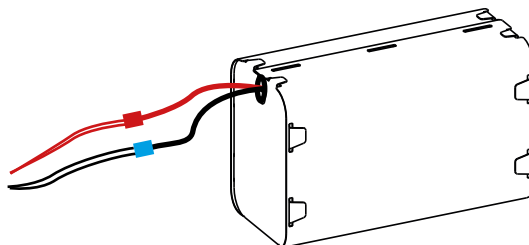

**Batteries are supplied in a thermally insulated casing. It is strictly forbidden to remove this casing as this could cause irreversible damage to the batteries.**

- 7 Position the batteries so that they rest against the rear jack feet.

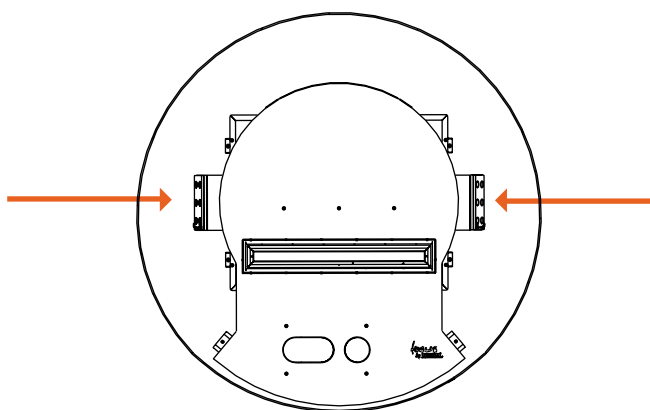

- 8 **Perform a power-up test on the device to make sure it is properly connected.**  
To do this, open the control panel and turn the button from OFF to ON.

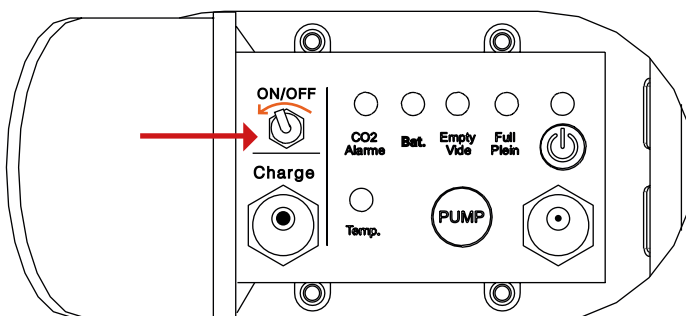

5 seconds after pressing the switch, the display LEDs should light up once in succession to indicate that the card has been powered up properly.



**WARNING : this action must only be carried out by a qualified person and only when the batteries are connected and installed, otherwise it will damage the autonomy of the appliance and could cause electronic damage to the burner.**



## Positioning the finishing side panels

9

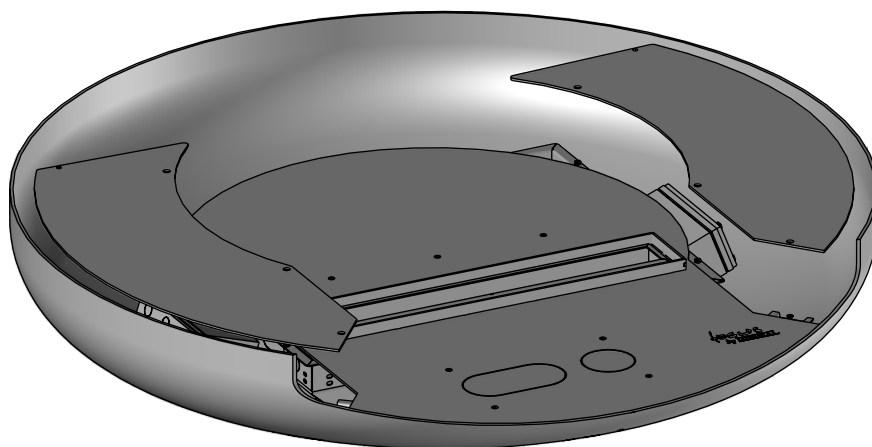

10 Secure with the 6 (M4) screws supplied

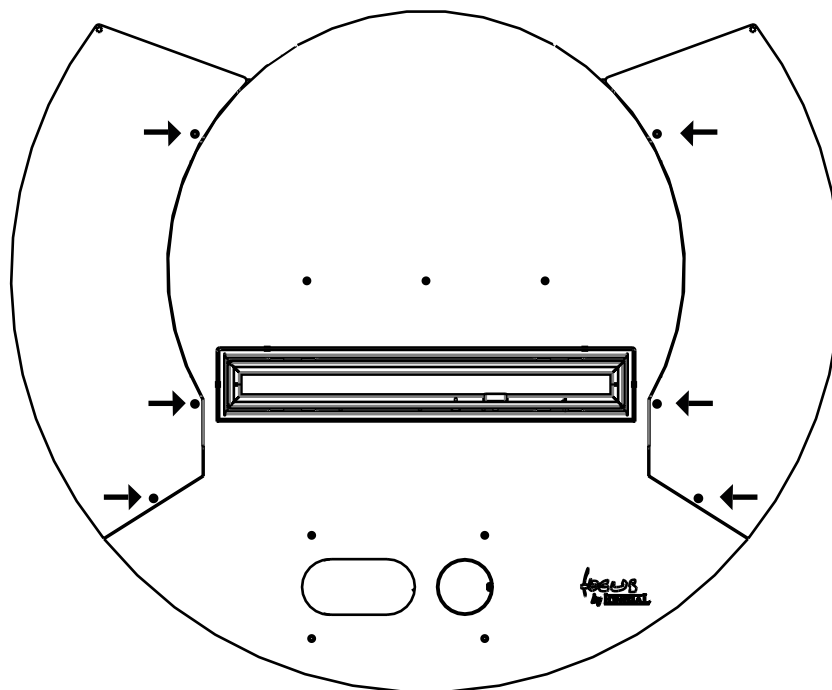

## Loading the burner

To maximise battery life, we recommend that you charge the device once it has been installed.  
During charging, the ON/OFF button must be in the OFF position.  
Charging time: minimum 12 hours.



**It is strictly prohibited to turn on the device during charging.**

**To ensure optimal use of your device and to preserve the lifespan of your batteries, we ask you to set the ON/OFF switch to the OFF position after each use.**

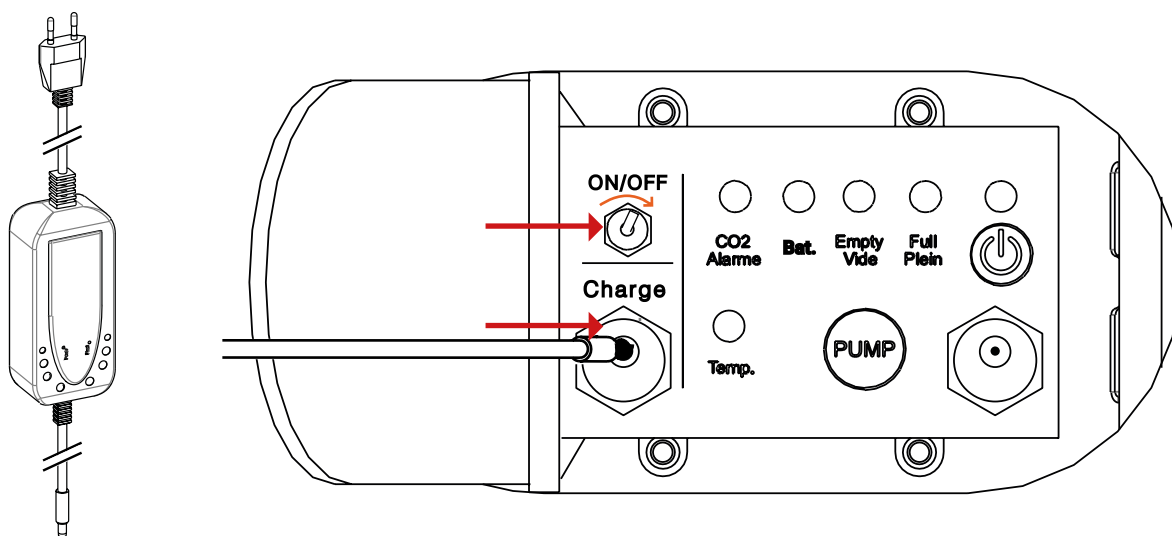

Log 1



Log 2



Log 3



Log 4



Log 5



Log 6



Log 7



Log 8



Log 9



Log 10



Fake embers



Black vermiculite

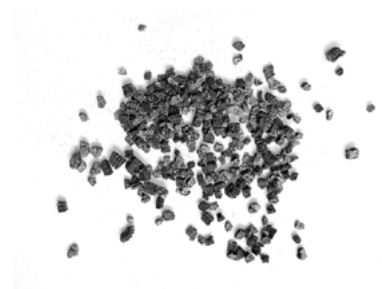



Only the decorative elements provided with this device should be used.  
Installation must be carried out strictly according to the instructions on the following pages.



Keep access to the hatches clear. If a log is broken or damaged, remove it immediately to avoid damaging the burner.

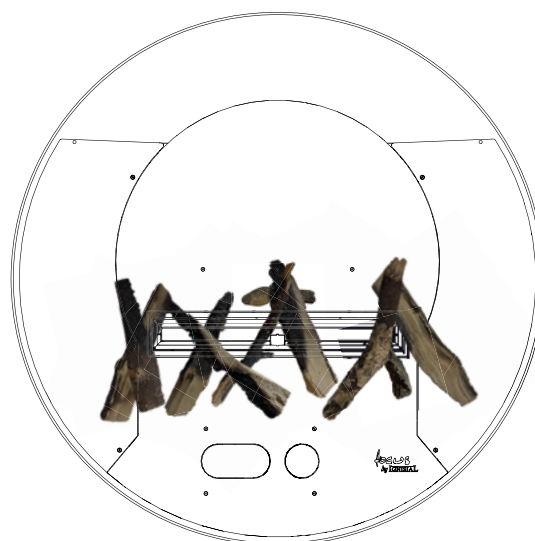

1

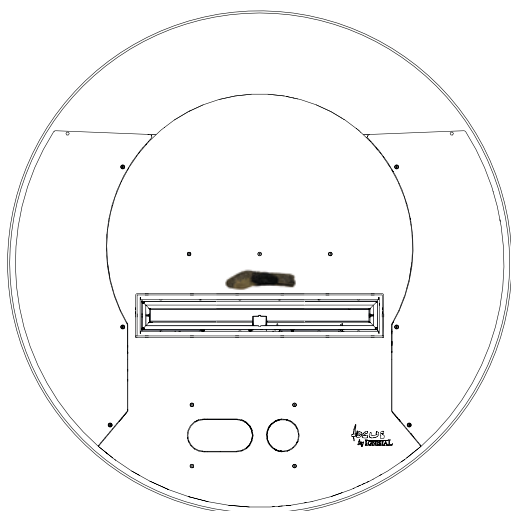

2

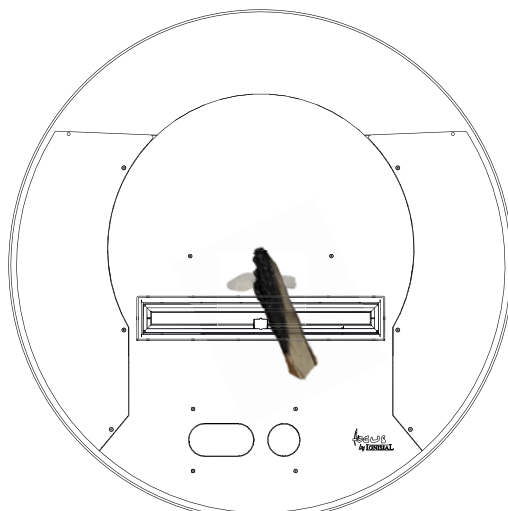

3

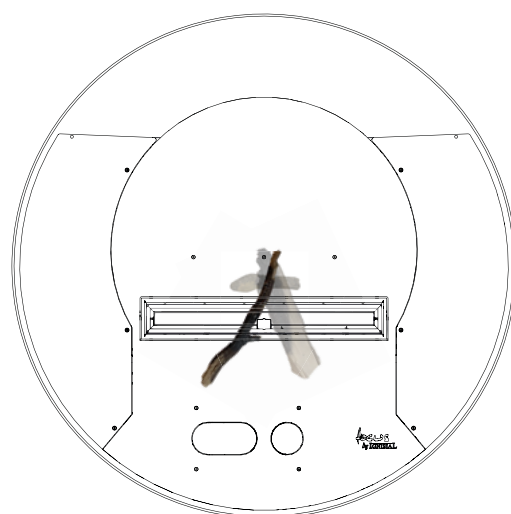

4

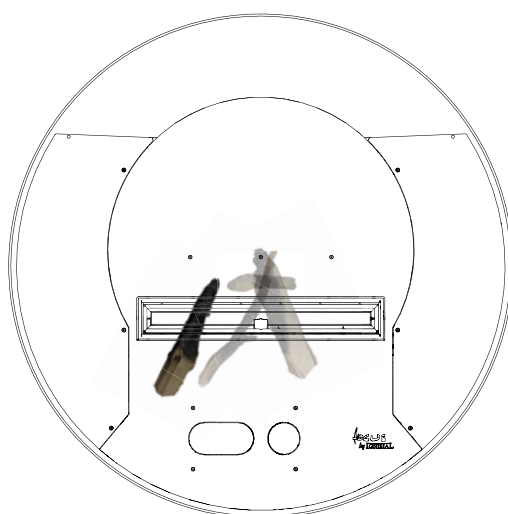

5

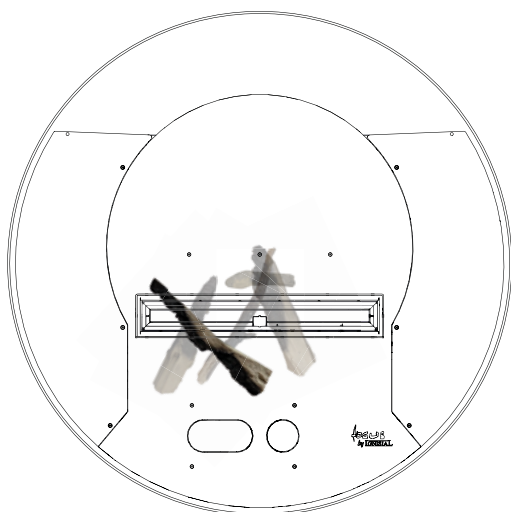

6

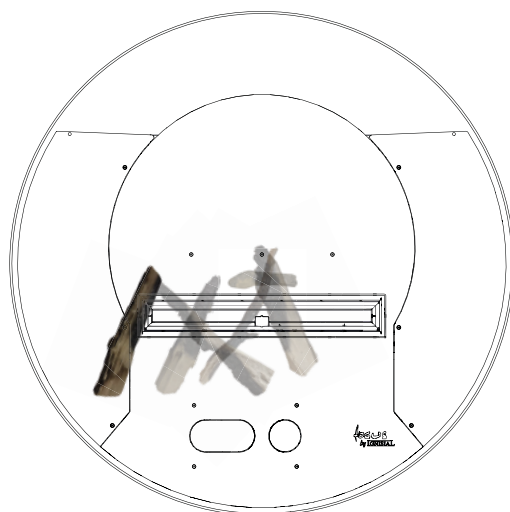

7

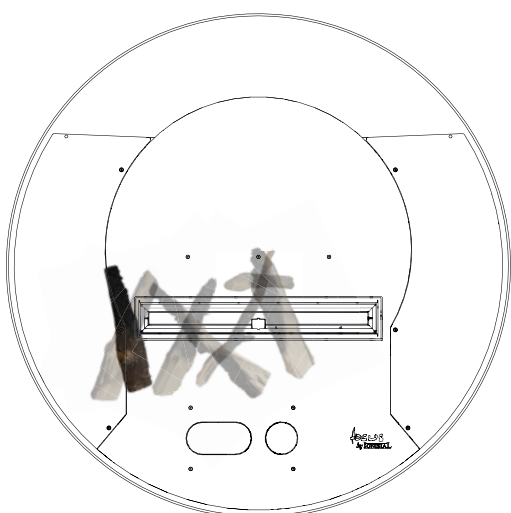

8

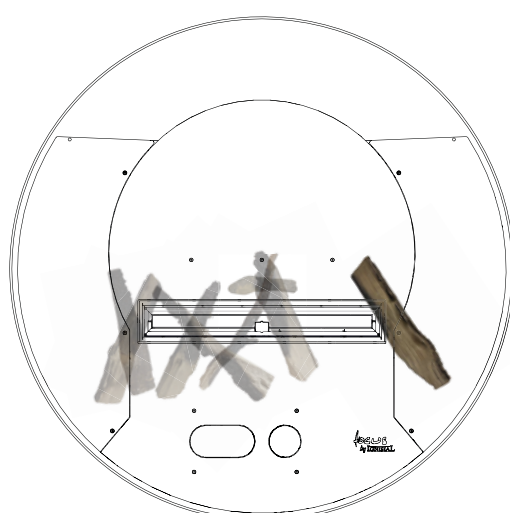

9

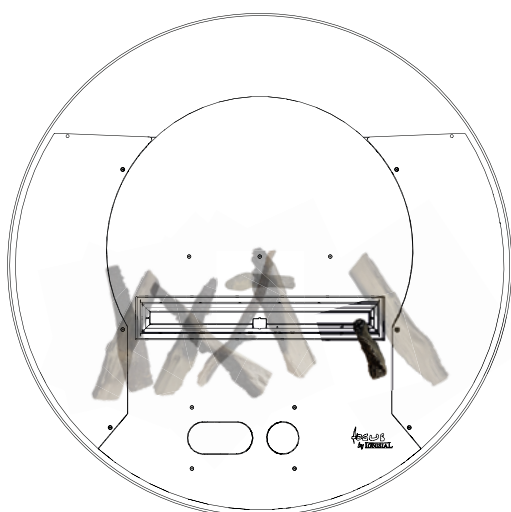

10

Place the last log, then distribute the vermiculite and the fake embers in the red area to your liking

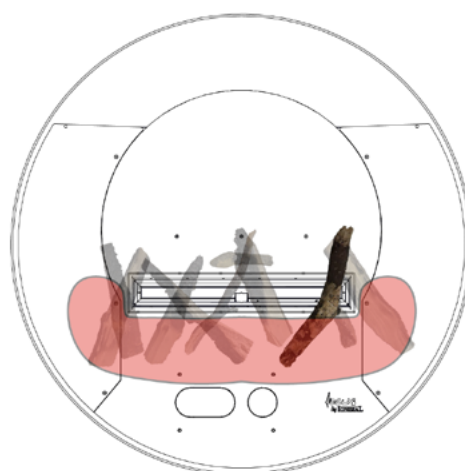



## FUEL WARNING :

**The fuel to be used must be only 96% nonregenerated denatured ethyl alcohol in liquid form and must not be drunk.**

The use of a fuel other than that recommended by IGNISIAL PARIS could have the following effects:

- Inability to detect ethanol in the tank, which will make it impossible to start the burner, with a very high risk of overflow.
- Damage to pump and filter.
- Creation of a deposit at the bottom of the manifold, leading to odour problems.

We recommend the use of the following ethanol to ensure the best durability of your appliance's components and the best flame experience:

- Aluflam (on sale at [www.ignisial-paris.com](http://www.ignisial-paris.com))

**The ethanol used must be at a temperature above 15°C.**

Outside this temperature range, detection problems in the tank, in the combustion manifold and in the leak detection zones may occur.

This could lead to overflowing and an inability to start.

Fuel should only be stored or transported in stainless steel or plastic containers.

Ethanol must be kept out of the reach of children.

When filling, do not smoke and keep away from open flames.

The tank may only be filled once the burner has stopped and cooled down, and only via the filling point (see p. 17), never directly via the burner manifold.

Once the tank has been filled, if it is not empty, store the canister away from the fireplace.

**Full or empty ethanol containers must be put away before the burner is lit.**

It is strictly forbidden to store ethanol near the fireplace.

If ethanol accidentally spills on the burner or overflows during refuelling, clean and dry the burner and firebox thoroughly.

The burner will be blocked and cannot be lit for 12 hours. Children must not fill, light or extinguish the burner. The use of any other fuel is prohibited, as is the addition of any additive to the liquid by the user.

## IF THERE IS A DAMPER :

As well as regulating the flue, the purpose of the damper, located on the flue, is to be able to block the flue when it is not in use.

Before igniting, check the position of the key, as the direction of the lever indicates the position of the damper. To change the position, pull the key towards you, turn it slightly and push it back to obtain one of the 4 possible positions of the damper disc inside the flue.

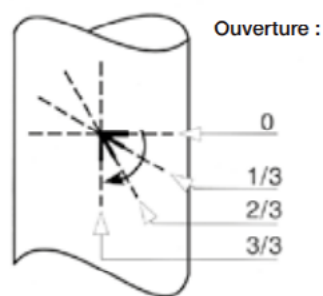

**To ensure that your appliance operates properly and benefit from the guarantee, it is imperative to use positions 1/3 and 2/3 only, avoiding position 3/3 (open) because of the risk of disturbing the flame.**

Above all, **it is forbidden to turn the button to position 0 (closed) while the appliance is running**, as this could damage the burner.





## 1ST USE AFTER INSTALLATION

The first ignitions may generate some odors due to the initial heating of the materials that make up the burner and the combustion chamber. Once the burner is installed, and to validate a proper connection to the power transformer, a partial filling of the tank is recommended to check the different functions of the burner.



For the first ignition, we recommend filling the burner with approximately 2.5 liters of ethanol.

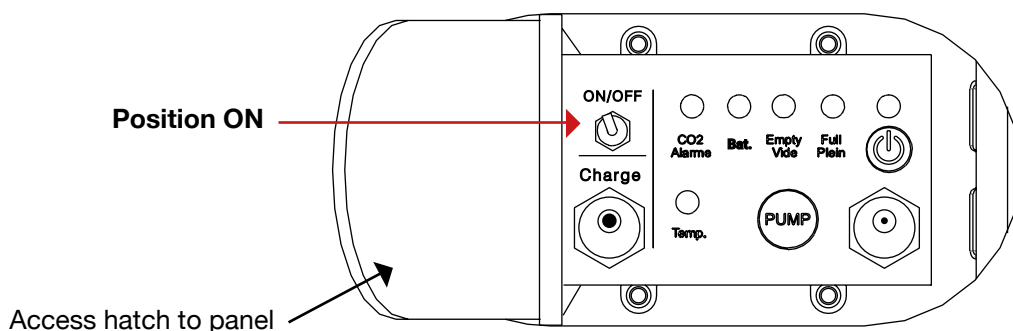

(Instructions for filling and ignition are provided on pages 17 to 20)

- 1
  - Lift the cover over the burner control panel.
  - Make sure that the power switch is in the ON position. If it is not, change the position.
  - 5 seconds after pressing the switch, the display LEDs will light up once in succession.



2

Press and hold the POWER button  (3 to 5 seconds) until you hear a beep  BIP, then press down on the back of the filling hatch to open it to the stop. Once the hatch is open, release the POWER button. The green POWER button indicator should flash.

 Press and hold the POWER button  (3 to 5 seconds)  BIP + Press on the filler flap to open it

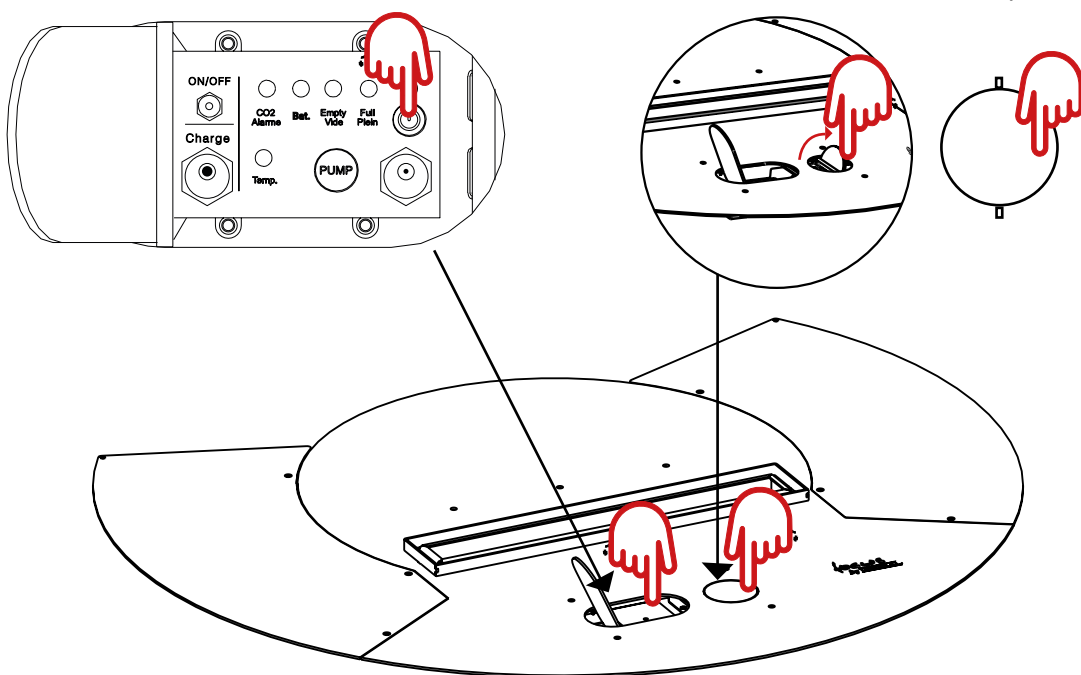

- 3
  - Place the external pump near the hatches on the microfibre cloth provided to avoid scratching the burner surface.
  - Connect the external pump power cable to the female port on the control panel to the right of the PUMP button.
  - Fit the metal ring on the burner hose.
  - This ring ensures that the hose is held in place during filling.*
  - Insert the canister hose into the bottom of your ethanol canister.

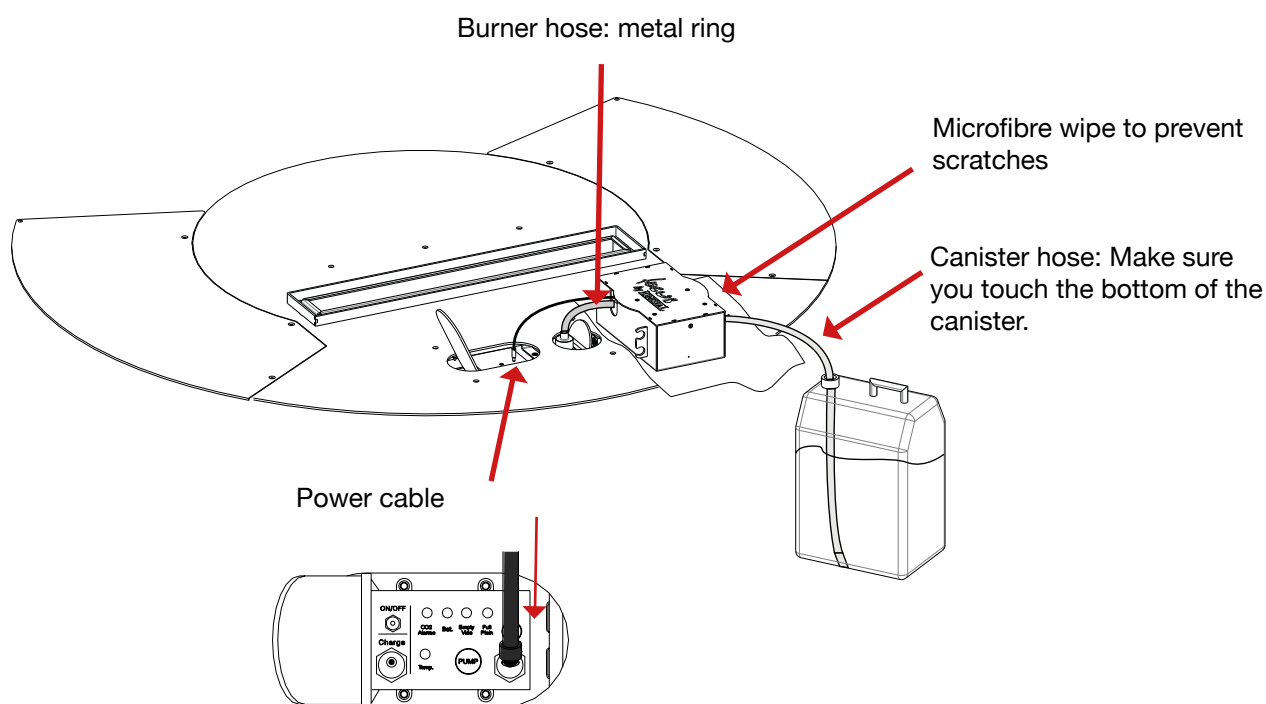

- 4
 

**Press the PUMP button** to start filling.

Filling can be stopped at any time by pressing the PUMP button again. It works like an on/off button.

**i** The pump stops automatically when the top level of the tank is reached. To fill the tank completely (9 litres), it may be necessary to stop the pump, insert the canister hose into the new ethanol canister and restart the pump.

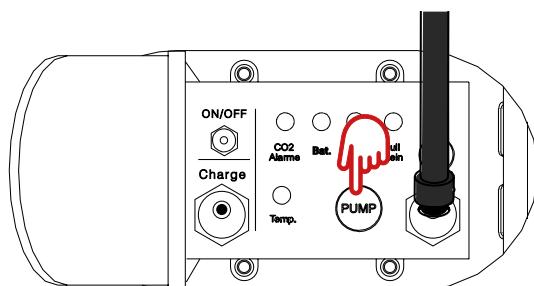

**i** **Reminder capacity of tank : 9litres**

- 5** Once the pump is switched off, roll up the hose, disconnect and remove the pump. Close the hatches.

- 6** Store the can away from the burner after filling and before lighting the fire.

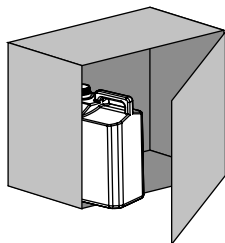

The fuel should be stored at a reasonable distance (min 1 metre) from the fireplace (if possible in another room of the house) with other household products, for example.  
Remember: ethanol must be stored at a temperature above 15°C.





## **APPLIANCE UNSAFE DUE TO INCORRECT FILLING**

In the event of overflow during filling a  <sup>BIP</sup> be audible and all the LEDs on the control panel will be on (see p.23). The appliance will be clamped for 12 hours minimum. The ethanol outside the tank should be wiped up as much as possible using a kitchen paper, so as not to damage either the firebox or the burner. Any remaining ethanol that cannot be removed should eventually evaporate.

- 1 If you have not filled your burner, we advise you to check the ethanol level before lighting.  
If the burner displays the reserve indicator (steady Power LED + flashing empty EMPTY LED), your burner is running out of fuel (less than an hour of autonomy).

## 2.1 CASE 1: IGNITION USING THE CONTROL PANEL

- Lift the cover over the burner control panel.
- Press the POWER button briefly.  
- Close the control panel cover.

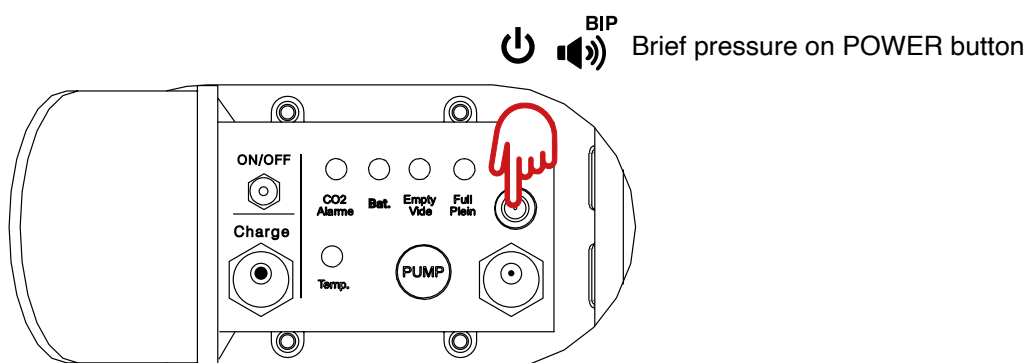

## 2.2 CASE 2: IGNITION USING THE REMOTE CONTROL

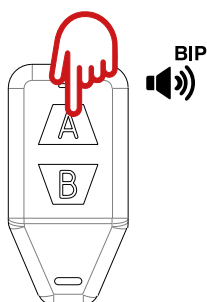



Press button A on the remote control 

- 3 The burner starts. The manifold fills with ethanol. When the level is sufficient, the fuel ignites. A small flame appears.

 If the burner does not start, an LED appears on the control panel and a second buzzer sounds. (see p. 23 for the definition of the different control panels).

## CASE 1: SWITCHING OFF USING THE CONTROL PANEL

- Lift the cover over the burner control panel.
- Press the POWER button briefly. 
- The burner must emit a  and the LEDs should light up and go out one after the other. The fireplace will then consume the amount of ethanol left in the manifold (extinction after 2 to 5 minutes).

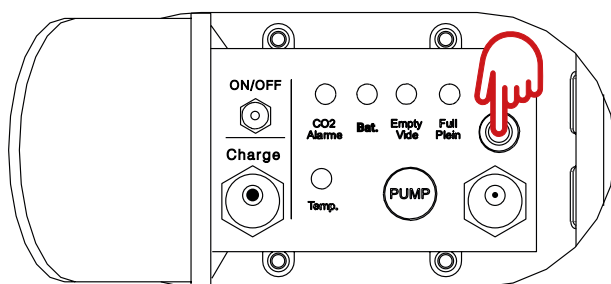

Brief pressure on POWER button

## CASE 2: SWITCHING OFF USING THE REMOTE CONTROL

- Press button B on the remote control 
- The burner will then consume the amount of ethanol left in the manifold (extinction after 2 to 5 minutes).

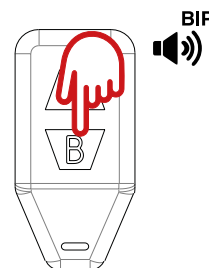

## CASE 3: NO ETHANOL LEFT

If there is not enough ethanol to supply the pump, the burner will emit an audible signal and switch-off. The burner will then consume the quantity of ethanol left in the manifold (extinction after 2 to 5 minutes).

## CASE 4: THE APPLIANCE SWITCHES OFF AUTOMATICALLY

Refer to the control panel display (see p. 23)

To ensure optimal use of your device and to preserve the lifespan of your batteries, we ask you to set the ON/OFF switch to the OFF position after each use.

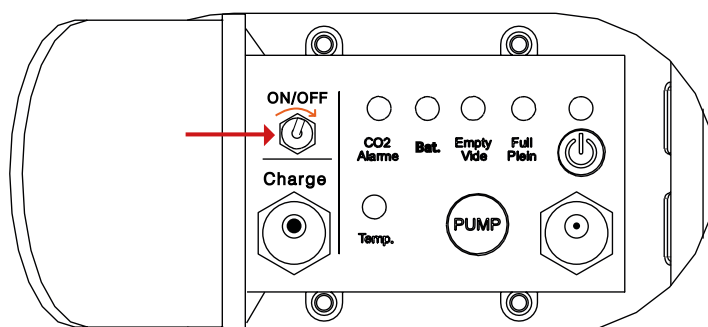





# Checking the status of the burner

EN

To find out about the burner's condition, you can perform a brief check to see if there is enough ethanol or if the temperature of the manifold is low enough.

- Lift the flap hiding the burner display panel.
- Press the POWER button  twice in quick succession until you hear a  BIP.
- The burner will then perform a complete check of the various sensors.

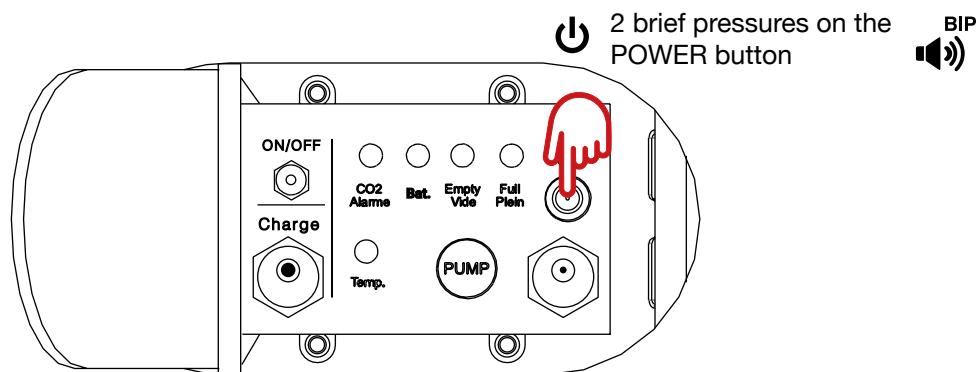

Tip: If the Empty LED flashes, the burner is on reserve. We recommend refilling the ethanol tank.

A		<p><b>LED POWER fixed :</b> Burner in operation.</p>
B		<p><b>LED POWER flashing :</b> Open hatch for filling.</p>
C		<p><b>LED EMPTY fixed</b> Burner with empty tank.</p>
D		<p><b>LED POWER fixed + EMPTY LED flashing:</b> Burner at the end of the tank. <b>Less than one hour of autonomy.</b></p>
E		<p><b>LED FULL/PLEIN fixed :</b> Burner with full tank.</p>
F		<p><b>LED FULL/PLEIN fixed + POWER fixed :</b> Burner with full tank in operation.</p>

G		<p><b>LED TEMP. flashing :</b> Burner with hot manifold. <b>Burner cannot be lit or opened.</b></p>
H		<p><b>LED CO2 ALARM fixed :</b> CO2 level in the surrounding air is too high. Ventilate the room immediately and contact the installer.</p>
I		<p><b>All LEDs flashing :</b> Ethanol level in tank too high. <b>Unable to start.</b> Open the fuel filler flap and drain off any excess ethanol. <b>Burner in safety mode. Burner cannot be lit for 12 hours.</b> <b>May occur during a sudden movement of the fireplace.</b></p>
J		<p><b>FULL/PLEIN LEDs</b> <b>+ EMPTY/VIDE</b> <b>+ BAT.</b> <b>+ CO2/ALARME Fixed :</b> Leak or overflow fault. Mop with a cloth if there is a lot of spillage. <b>Burner in safety mode. Burner cannot be lit for 12 hours.</b></p>
K		<p><b>LEDs BAT.</b> <b>+ CO2/ALARME</b> <b>+ TEMP clignotante successivement :</b> Injection problem in the manifold. The manifold filling time has exceeded the safety time. The burner has tripped. Contact your installer.</p>
L		<p><b>LED BAT. fixed</b> Weak batteries. Please charge them up (see p.12).</p>



**Before moving the burner and removing it from the firebox, it must be emptied. Caution: moving an undrained burner may damage its components.**

- 1** Reach under the firebox to the drain screw. Using a 15 mm open-end wrench.



- 2** Empty the bioethanol tank, keeping the screw and gasket.

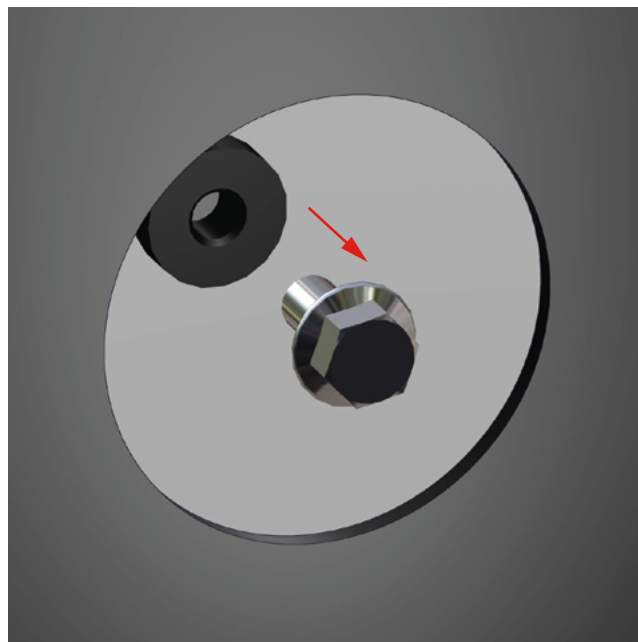

- 3** Once the burner is empty, screw on the plug with the gasket.

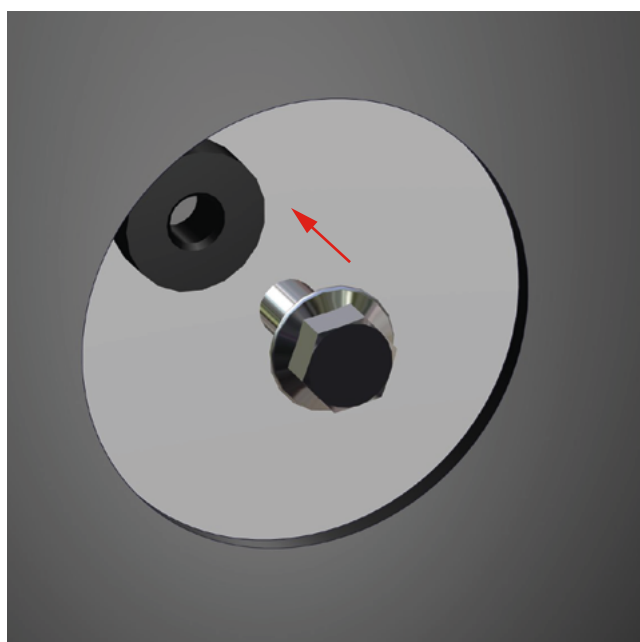

## 1. Introduction

Our ethanol burner is guaranteed\* from the date of invoice for the period specified in paragraph 5: guarantee period. If your appliance malfunctions, please contact your retailer or our after-sales service by e-mail:

**info@focuscreation.com.**

*\*The terms and conditions of the appliance guaranty are clearly defined in paragraphs 2 and 3 of this document..*

## 2. Conditions of application of the guarantee

The guarantee only applies when :

- The installation was carried out in strict compliance with all the information (instructions, sheets, cardboard forms) supplied with our products.
- After examining the equipment, if it is clear that it has not suffered any impact And has been used in accordance with the rules for use and maintenance
- The customer is able to present the original purchase invoice and the signed guarantee contract.

## 3. Guarantee exclusions

The guarantee does not cover :

- Damage caused by work carried out on our products by an unauthorised third party (other than a Focus installer) other than that illustrated and explained in our instructions.
- Damage caused by modifying the appliance or by using it for purposes other than those specified in the instructions. Removing the top plate of the burner will invalidate the guarantee.
- Damage caused by failure to maintain the equipment or neglecting to do so.
- Damage due to external causes.
- Visible damage that the end customer did not mention at the time of purchase.

## 4. Litigation

In the event of disputes, the Commercial Court of Montpellier shall have sole jurisdiction, regardless of the place of delivery, even in the event of multiple defendants or guarantee claims.

## 5. Guarantee period

- Burner: 2 years
- Accessories (filling pump, batteries, charger): 2 years
- Small accessories for burner not guaranteed
- Consumables not guaranteed

In any event, the supplier remains responsible for the legal guarantee in the event of defects or hidden faults in the product.

## **DECLARATION OF CONFORMITY**

**DU PASSÉ AU PRÉSENT  
ZI 65 RD 931  
60650 SAINT-PAUL**

Declares that the composition of burners from the E-GNIS range complies with the following Low Voltage Electrical and EMC Directives:

- NF EN IEC 55014-1 (CEM)
- NF EN IEC 55014-2 (CEM)
- NF EN 60335-1 (CE)
- NF EN 60335-2-30 (CE)



Laurent CONFRERE  
General Manager

Saint-Paul, February 13, 2024



## COMPATIBILITY STATEMENT

**DU PASSÉ AU PRÉSENT  
ZI 65 RD 931  
60650 SAINT-PAUL**

Declares that burners from the E-GNIS range must be used with an ethanol for bio-fireplaces that shows no trace of dye and has the following composition:

- 96% plant-based alcohol
- 3% water
- 1% denaturant

A bio-ethanol from the following brands has been tested to date and is compatible with our burners from the E-GNIS range:

- ALUFLAM
- FANOLA
- DECOFLAME
- TERAFLAME

We highly recommend using ALUFLAM ethanol to ensure the best user experience.



Laurent CONFRERE  
General Manager

Saint-Paul, February 13, 2024

IGNISIAL PARIS - 65 RD 931 60650 SAINT PAUL

Version : 29/01/2025